

DRG

DTI

PZ25-12000021
01/07/2026

ARCHITECTS
Associates, Inc. AA26001933

ARCHITECTURE | PLANNING | INTERIOR DESIGN

14125 NW 80th Avenue Suite 303
Miami Lakes - Florida -33016
info@dtlarchitect.com
www.dtlarchitect.com

STATE OF FLORIDA
CARLOS PIZARRO
AR0013079
REGISTERED ARCHITECT

Carlos Pizarro, R.A.
AR - 0013079

| |
|------------|
| Revisions: |
| |
| |
| |
| |
| |
| |
| |

OWNER / DEVELOPER:

RED LINK MANAGEMENT
CORP
2750 NE 185TH ST. #304
AVENTURA, FLORIDA 33180

PROJECT:

FOLIO 4942-03-27-0012
PROPOSED SHELL BLDG @
2100 WEST ATLANTIC BLDG
2100 W ATLANTIC BLVD
POMPANO BEACH, FLORIDA 33069

| |
|-------------------------|
| Job Number: 24109.01 |
| File name: |
| Issued Date: 05-14-2025 |
| Drawn by: A.S |
| Checked by: T.R. |

SHEET NAME

ROOF PLAN
BUILDING
2

SHEET NUMBER

A-1.1

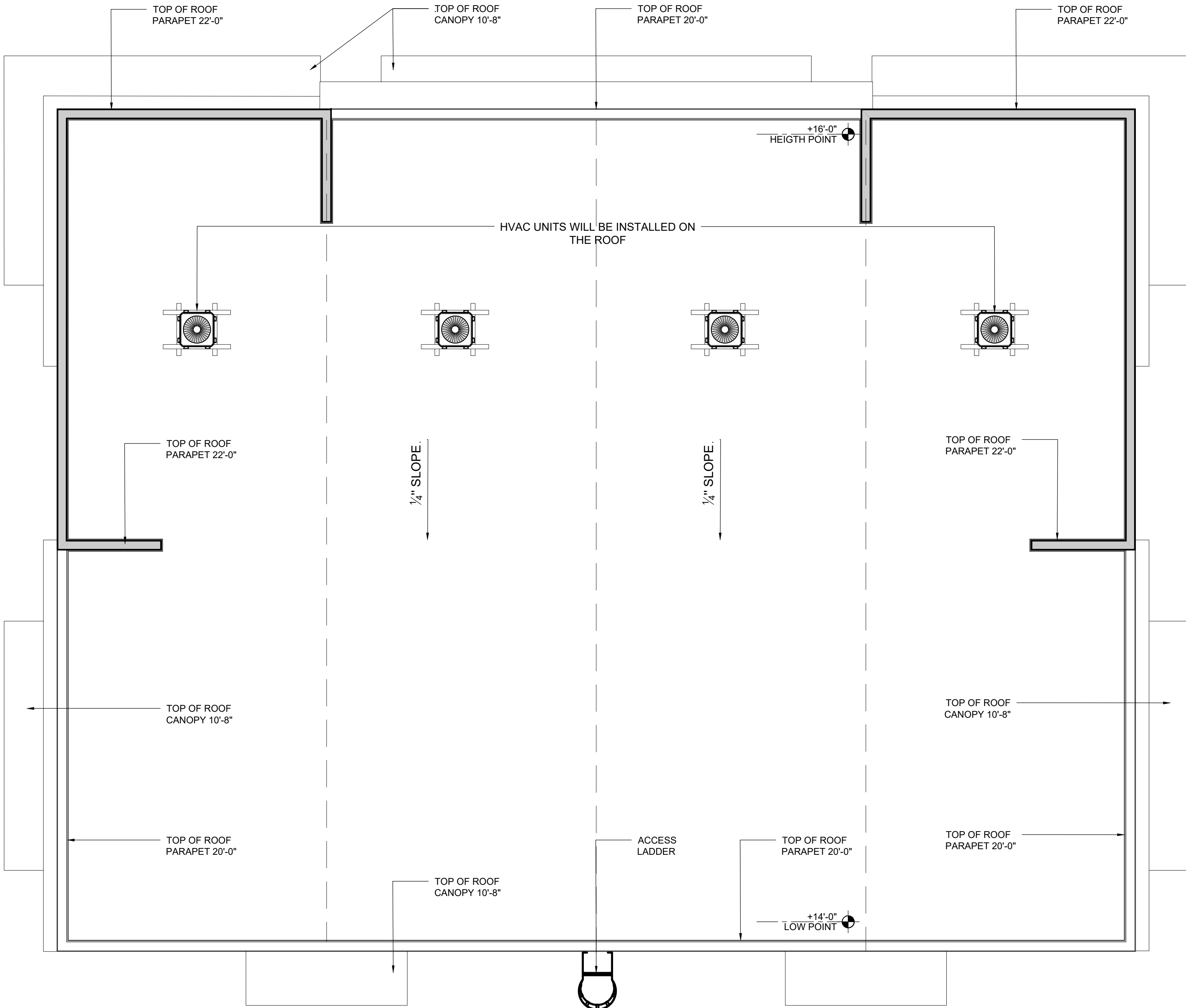

ROOF PLAN BUILDING 2
SCALE: 1/8" = 1'-0"

NOTES

- ROOFTOP EQUIPMENT SHALL BE SCREENED FROM VIEW BY PARAPET, MASONRY WALL OR OTHER ARCHITECTURAL FEATURES OF THE BUILDING. SUCH ENCLOSURES SHALL BE AS HIGH OR HIGHER THAT THE HIGHEST PORTION OF THE EQUIPMENT OR APPARATUS BEING SCREENED.
- SUCH AS AIR CONDITION/ HEATING UNITS AND STATIONARY EMERGENCY GENERATORS SHALL BE ENCLOSED BY WALL, SOLID FENCE, HEDGE OR OTHER DEVICES THAT WILL EFFECTIVELY SCREEN SUCH EQUIPMENT FROM PUBLIC VIEW.